

ESTOLGA 3000 / DRY SEAL / TYPICAL INSTALLATION INSTRUCTIONS

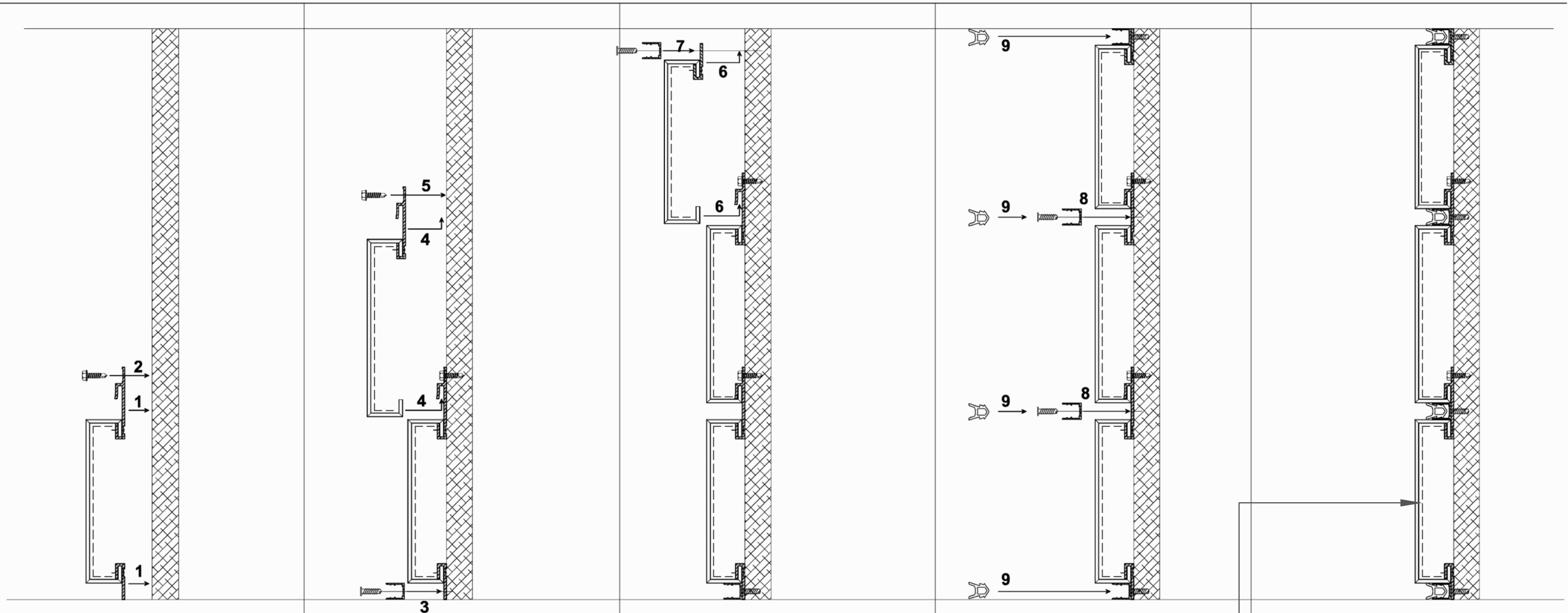

STEP 1 & 2:
 (1) Place the first panel by aligning it to the starting level at bottom / base and (2) install the fastener as shown.

STEP 3, 4, 5:
 (3) Install the sealant channel (as required depend on base conditions) with a flathead fastener. (4) Slip and slide the next panel into joint attachment and (5) install the fastener as shown.

STEP 6 & 7:
 (6) Slip and slide the last panel. (7) Install the sealant channel (as required depend on parapet, coping, window. etc. conditions) with a flathead fastener.

STEP 8 & 9:
 (8) Install the sealant channel with a flathead fastener between the panels and (9) apply the silicone gaskets as shown.

FINAL LOOK

Note: Panel stiffener installed during panel fabrication, included upon delivery of panels, as required.

***Instruction steps may need modification depend on special field conditions.